

**SPECIFICATIONS**

**PSI / Temperature Rating:** 150 PSI / 275° F  
**Cartridge:** AISI Type 304 stainless steel  
 AISI Type 17-7 PH stainless steel spring  
**Body Material:** Ductile Iron ASTM A536-80  
 Class 50-40-18  
**End Connections:** ANSI 150 Lb. Flanges 2-1/2" and 3"  
**Seals:** EPDM O-Rings  
**Body Tappings:** 1/4" NPT with P/T test valves  
**Isolation Options:** Butterfly Valve

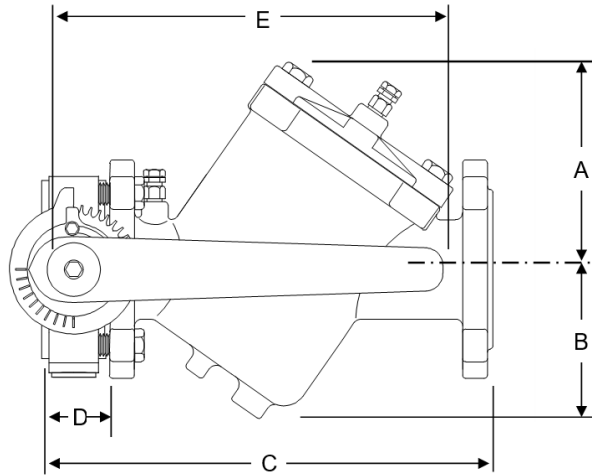
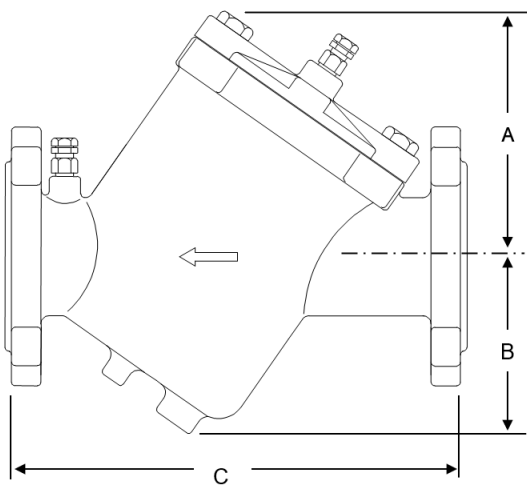

**DIMENSIONS & WEIGHTS (NOMINAL)**

All dimensions are for planning purposes only and may change without notice.

SIZE	MODEL NO.	A HEIGHT	B HEIGHT	C LENGTH	D	E	Cv <sup>1</sup>	WEIGHT (LBS.)
2-1/2", 3"	3UF_B_	5.3	4.3	11.9	N/A	N/A	119	28
2-1/2"	3UF_M_	5.3	4.3	13.6	1.8	10.7	119	40
3"	3UF_N_							

**NOTES**

<sup>1</sup> Cv measured without cartridge

**FLOW RATES (+/-5%)**

SIZE <sup>2</sup>	MODEL NO.	HEAD LOSS IN FEET <sup>3</sup>	PSID RANGE	GPM		
				MIN	INCREMENT	MAX
2-1/2", 3"	3UF1__	3.5	1-14	12.0	2.0	114.0
	3UF2__	7.4	2-32	18.0	3.0	171.0
	3UF4__	13.4	4-57	24.0	4.0	228.0
	3UF8__	30.0	8-128	36.0	6.0	342.0

**MODEL NUMBER SELECTION<sup>4</sup>**

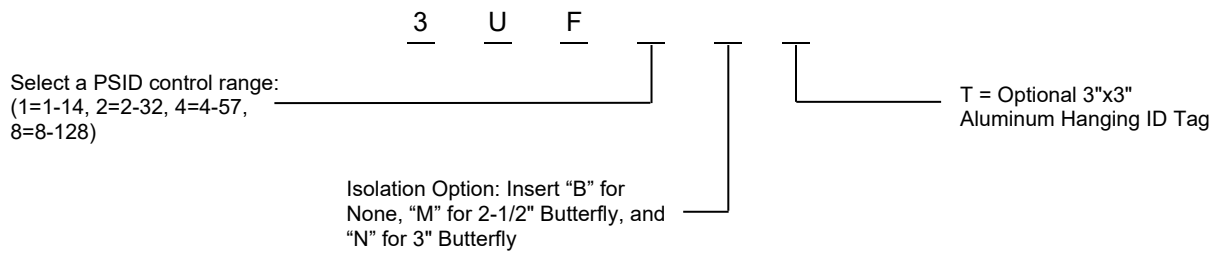

**NOTES**

<sup>2</sup> 2" Reducing flanges can be used. Consult your local pipe fitting supply house or contact the factory for assistance.

<sup>3</sup> Head Loss in Feet is provided for pump head calculations. (1 PSI = 2.307 Feet of Water)

<sup>4</sup> Model no. and flow rate are indicated on label affixed to body.