



SPECIFICATIONS

PSI / Temperature Rating:	450 PSI / 250° F
Cartridge:	AISI Type 304 stainless steel
Body Material:	AISI Type 17-7 PH stainless steel spring
Cartridge Seal:	304 Stainless Steel (Certified Lead Free ¹)
End Connections:	EPDM O-Ring
Union Seal:	Female NPT
Assembly:	EPDM O-Ring
	Valve comes fully assembled

DIMENSIONS & WEIGHTS (NOMINAL)

All dimensions are for planning purposes only and may change without notice.

SIZE	MODEL NO.	A LENGTH	B HEIGHT	WEIGHT (LBS.)
1/2" x 1/2"	PR1_EE	4.02	1.18	1.1
1/2" x 3/4"	PR1_EF	4.03	1.40	1.1
3/4" x 1/2"	PR1_FE	4.14	1.18	1.1
3/4" x 3/4"	PR1_FF	4.14	1.40	1.2

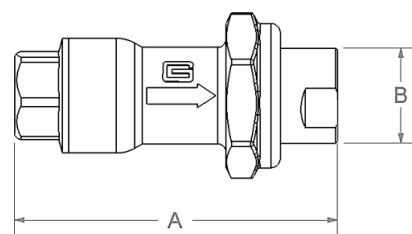

FLOW RATES (+/-5%)

SIZE	MODEL NO.	HEAD LOSS IN FEET ²	PSID RANGE	GPM
1/2", 3/4"	PR11_	3.5	1-14	.33, .50, .67, 1.00, 1.33, 1.67, 2.00, 2.33, 2.67, 3.33, 4.00, 4.67, 5.00
	PR12_	7.4	2-32	0.55, 0.75, 1.00, 1.25, 1.50, 1.75, 2.00, 2.25, 2.50, 2.75, 3.00, 3.50, 4.00, 5.00, 6.00, 7.00, 8.00
	PR14_	13.4	4-57	.75, 1.00, 1.33, 2.00, 2.67, 3.33, 4.00, 4.67, 5.33, 6.67, 8.00, 9.33, 10.00, 11.00
	PR18_	30.0	8-128	1.10, 1.50, 2.00, 3.00, 4.00, 5.00, 6.00, 7.00, 8.00, 10.00, 12.00, 14.00, 16.00

MODEL NUMBER SELECTION³

Select a PSID control range (1=1-14, 2=2-32, 4=4-57, 8=8-128)

Select Fixed End (1/2"=E, 3/4"=F)

Select Union End (1/2"=E, 3/4"=F)

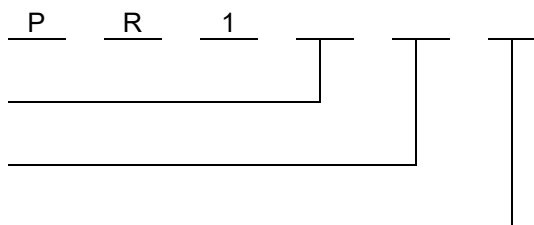

NOTES

¹ Valve contains less than 0.25% lead content by weight on wetted surfaces. 3rd party certification for CA AB1953 and NSF-61 Annex G was performed by ALS Labs. Certificate available on website. Certification label is applied to valve surface.

² Head Loss in Feet is provided for pump head calculations. (1 PSI = 2.307 Feet of Water)

³ Model no. and flow rate are indicated on label affixed to body.

This specification © 2024 Griswold Controls

1700 Barranca Parkway, Irvine, CA 92606
(949) 559-6000 Fax (949) 559-6088
www.GriswoldControls.com