

SPECIFICATIONS

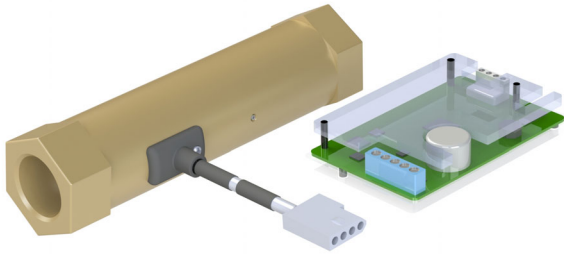

PSI/Temperature Rating: 400 PSI / 200° F
Service: Chilled water, hot water, or water up to 50% Glycol
Flow Element: 2-Way Ceramic Disc
Body Material: Forged Brass (No Lead¹ Brass Available)
End Connections: Brass FNPT or SWT
Close Off ΔP: 250 PSI – ANSI Class 4
Cv: Electrically adjustable
Actuator Voltage: 22-35 Vac/Vdc
Actuator Cycle Time: 52 seconds

ACTUATED BALL Cv² AND FLOW RATE TABLE (GPM)

SIZE	STROKE	DIP SWITCH SETTINGS		FLOWRATE (GPM) @ DIFFERENTIAL PRESSURE (PSI)											
				2-Position HVAC Apps		HVAC Modulating Apps									
					Cv	0.5	1.0	1.5	2.0	2.5	3.0	3.5	4.0	4.5	5.0
1/2"	40%	On	Off	0.4	0.5	0.6	0.7	0.8	0.9	0.9	1.0	1.1	1.1	1.3	1.6
	60%	Off	On	1.0	1.4	1.7	2.0	2.2	2.4	2.6	2.8	3.0	3.1	3.7	4.4
	80%	On	On	1.7	2.4	2.9	3.4	3.8	4.2	4.5	4.8	5.1	5.4	6.3	7.6
	100%	Off	Off	2.5	3.5	4.3	4.9	5.5	6.1	6.5	7.0	7.4	7.8	9.3	11.1
3/4"	40%	On	Off	0.4	0.5	0.6	0.7	0.8	0.9	0.9	1.0	1.1	1.1	1.3	1.6
	60%	Off	On	1.1	1.5	1.8	2.1	2.4	2.6	2.8	3.0	3.2	3.4	4.0	4.7
	80%	On	On	1.8	2.5	3.1	3.5	4.0	4.3	4.7	5.0	5.3	5.6	6.6	7.9
	100%	Off	Off	3.5	5.0	6.1	7.1	7.9	8.7	9.4	10.0	10.6	11.2	13.2	15.8

DIMENSIONS & WEIGHTS (NOMINAL) (measured in inches and lbs unless noted)

All dimensions are for planning purposes only and may change without notice.

SIZE	A	B	C	D	E	F	WEIGHT
1/2"	5.3	1.5	15.0	1.9	3.0	0.8	1.0
3/4"	6.0	1.5					

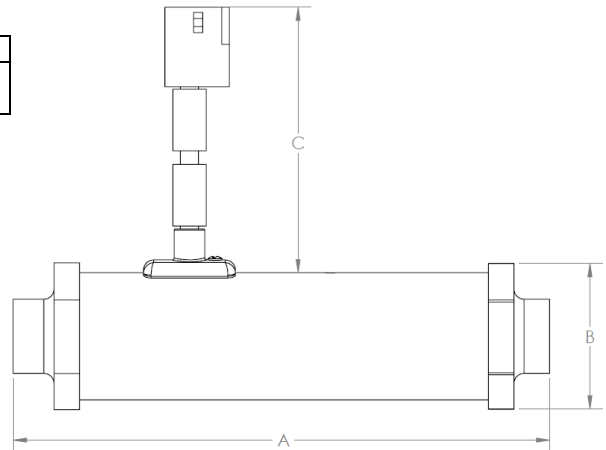
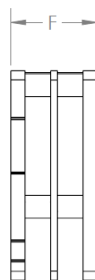
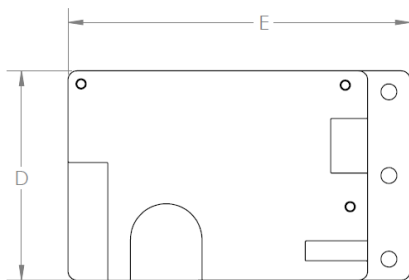

NOTES:

¹ No Lead brass contains less than 0.25% lead content by weight on wetted surfaces. 3rd party certification for CA AB1953 and NSF-61 Annex G was performed by ALS Labs. Certificate available on website. Certification label is applied to valve surface.

² The Cv is the gallons of water per minute (gpm) at 60°F that the valve will pass at 1 PSI pressure drop. Cv's are also used to calculate the pressure drop. $PSID=(Flow/Cv)^2$

MODEL NUMBER SELECTION

Select Valve Size (E=1/2"FNPT, L=1/2"SWT, F=3/4"FNPT, M=3/4"SWT)
Select an Actuator (1=Fail-safe with 2-10V Modulating, On/Off OR 3-point floating, 2=Non-Fail-safe On/Off or Modulating)
Select a Housing Type (S=Standard Brass, L=No Lead¹ Brass)

