

SPECIFICATIONS



PSI/Temp Rating: 250 PSI/400°F
Cartridge: AISI Type 304 Stainless Steel
 AISI Type 17-7 PH Stainless Steel
Body Material: AISI Type 304 Stainless Steel
Assembly: Valve comes fully assembled.

Valve is 100% Stainless Steel and therefore lead free.

FLOW RATES (+/-5%)

SIZE	MODEL NO	PSID RANGE	GPM
1/2", 3/4", or 1"¹	3551S	1.5-14	.33, .50, .67, 1.00, 1.33, 1.67, 2.00, 2.33, 2.67, 3.33, 4.00, 4.67, 5.00
	3552S	3.2-32	.55, .75, 1.00, 1.50, 2.00, 2.50, 3.00, 3.50, 4.00, 5.00, 6.00, 7.00, 8.00
	3554S	5.8-57	.75, 1.00, 1.33, 2.00, 2.67, 3.33, 4.00, 4.67, 5.33, 6.67, 8.00, 9.33, 10.00
	3558S	13-128	1.10, 1.50, 2.00, 3.00, 4.00, 5.00, 6.00, 7.00, 8.00, 10.00, 12.00, 14.00, 16.00

DIMENSIONS (NOMINAL)

All dimensions are for planning purposes only and may change without notice.

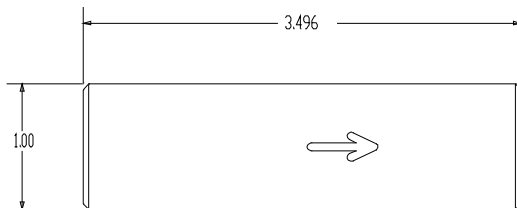

MODEL NUMBER SELECTION

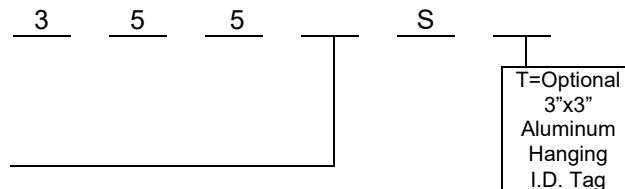

Select a PSID control range:
 (1=1.5-14, 2=3.2-32, 4=5.8-57, 8=13-128)

NOTES

¹ Housing is compatible with 1/2" or 3/4" SCH-40 pipe. 1/2": use fillet weld socket joint at inlet and fillet v-groove butt weld at outlet. 3/4": use fillet v-groove butt weld at inlet and fillet socket weld at outlet. Also compatible with 7/8" OD or 1" OD tubing. (0.065" wall max)