

SPECIFICATIONS

PSI / Temperature Rating: 400 PSI / 250°F
Body Material: Forged Brass ASTM B283-06
End Connections: Brass – NPT, Sweat or QuickPress¹
Union Seal: EPDM O-ring
Body Tappings²: (2) Bosses for CPTAs, Airvent. and Drain Valve
Options: Combination P/T Test Valve and Manual Air Vent (CPTA), Drain Valve, Coin Operated Airvent, Extension Option

DIMENSIONS & WEIGHTS (NOMINAL)

All dimensions are for planning purposes only and may change without notice.

SIZE	A - FIXED END CONNECTION		B - UNION END CONNECTION ³						C	WEIGHT (LBS.)	
	FNPT	SWT	FNPT		MNPT		SWT				
3/8"	N/A	1.7									
1/2"	2.0	1.9	1/2":1.0	3/4":N/A ⁴	1/2":1.0	3/4":1.2	3/8",1/2":0.8	3/4":1.1	1.2	0.3	
3/4"	1.9	1.9									
1"	2.2	2.2	1/2",3/4":1.0	1":N/A ⁴	1/2"-3/4":1.0	1":1.4	3/8",3/4":1.0	1/2":0.7	1":1.3	2.0	1.1
1-1/4"	2.6	2.6									
1-1/2"	2.8	2.8	1",1-1/4",1-1/2":1.7		1",1-1/4",1-1/2":1.7 ⁵		1",1-1/4":1.7	1-1/2":1.4	2.7	2.4	
2"	2.8	2.8	1-1/4",1-1/2":1.6	2": N/A ⁴	1",1-1/4":1.8	1-1/2":1.6	1-1/4",2":1.6	1-1/2":1.7	3.4	3.2	
2-1/2"	3.0	N/A	1-1/2" – 2-1/2": 1.2	3": 2.2	1-1/2"-2-1/2": 1.5	3": 2.5	2":2.0		3.7	5.1	
3"	3.2	N/A								5.6	

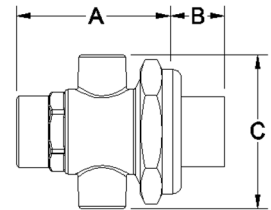

For QuickPress connections add 3.1" (1/2"), 3.6" (3/4"), 4.1" (1") to the FNPT length (A) listed for a valve.

MODEL NUMBER SELECTION

Select a Housing Size (0=1/2"-3/4", 1=1", 2=1-1/4"-1-1/2", 3=2", 4=2-1/2"-3")

Select an Accessory Package (0=No Port, B=CPTA, C=CPTA & Drain Valve, D=Coin-Op Airvent, E=Coin-Op Airvent and CPTA)

Extension Option⁶ (0=No, 1=1-1/2", 2=2")

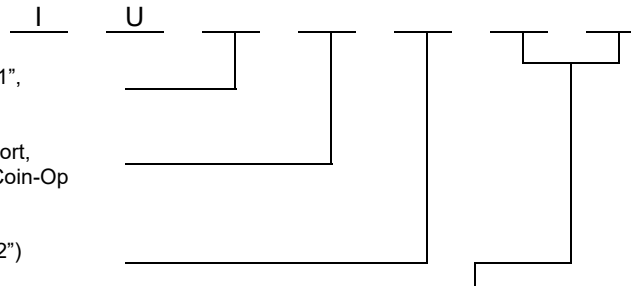

Valve	FIXED END OR UNION END ⁷ (No Union Tailpiece=Z)			UNION END ONLY ⁷
	Female Threaded	Female Sweat	QuickPress	Male Threaded
IU0	1/2"=E, 3/4"=F ⁴	3/8"=K, 1/2"=L, 3/4"=M	1/2"=2, 3/4"=3	1/2"=H, 3/4"=I
IU1	1/2"=E ⁸ , 3/4"=F ⁸ , 1"=G ⁴	3/8"=K ⁸ , 1/2"=L ⁸ , 3/4"=M ⁸ , 1"=N	1/2"=2 ⁸ , 3/4"=3 ⁸ , 1"=1	1/2"=H, 3/4"=I, 1"=J
IU2	1"=G ⁸ , 1-1/4"=P, 1-1/2"=Q	1"=N ⁸ , 1-1/4"=K, 1-1/2"=W	N/A	1/2"=H, 3/4"=I, 1"=J, 1-1/4"=S, 1-1/2"=T
IU3	1-1/4"=P ⁸ , 1-1/2"=Q ⁸ , 2"=R ⁴	1-1/4"=K ⁸ , 1-1/2"=W ⁸ , 2"=Y	N/A	1-1/4"=S, 1-1/2"=T, 2"=U
IU4	1-1/2"=Q ⁸ , 2"=R ⁸ , 2-1/2"=A, 3"=B	2"=Y ⁸	N/A	1-1/2"=T, 2"=U, 2-1/2"=C, 3"=D

NOTES

- ¹ QuickPress is available on 1/2" to 1" valves. Connections are compatible with popular press tools and are rated for maximum 200 PSI.
- ² Body Tappings for accessories are a leak proof metal to metal seal and do not require pipe dope or tape. Tape or dope should not be used.
- ³ For overall length, add union end connection length to body length.
- ⁴ Tailpiece is not available for this size. Male tailpiece used with coupling.
- ⁵ 1-1/4"-1-1/2" valves can also take 1/2"-3/4" MNPT tailpieces.
- ⁶ Extension Option includes accessory extensions for either 1-1/2" or 2" insulation.
- ⁷ Select the Fixed End First and the Union End Second.
- ⁸ Fixed end not available for this size. Union tailpiece only.

This specification © 2020 Griswold Controls

1700 Barranca Parkway, Irvine, CA 92606
 (949) 559-6000 Fax (949) 559-6088
 www.GriswoldControls.com

