

Accessory Flange

**SPECIFICATIONS:**

PSI / Temperature Rating: 125 PSIG / 250° F  
 Body Material: Steel pipe schedule 40  
 Body Tappings: 1/4" NPT and/or 3/4" NPT  
 Flanges: 150# Plate Flanges

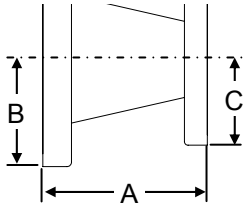

Flange Reducer



Weld Neck, Victaulic and Reducer Flanges

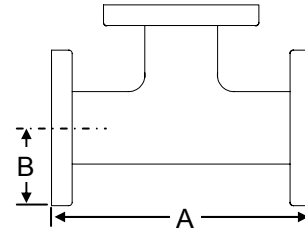

Flanged Tee

**DIMENSIONS<sup>1</sup> (NOMINAL)**

SIZE	ACCESSORY FLANGE - ONE 1/4" Port								
	WELD x FLANGE			GROOVE x FLANGE			FLANGE x FLANGE		
	A	B	BOLT	A	B	BOLT	A	B	BOLT
2-1/2"	4.0	3.5	4	6.0	3.5	4	5.0	3.5	4
3"	4.0	3.8	4	6.0	3.8	4	5.0	3.8	4
4"	6.0	4.5	8	8.0	4.5	8	6.5	4.5	8
5"	6.0	5.0	8	8.0	5.0	8	6.5	5.0	8
6"	6.0	5.5	8	8.0	5.5	8	6.5	5.5	8
8"	7.0	6.8	8	9.0	6.8	8	7.0	6.8	8

SIZE	FLANGE REDUCER <sup>2</sup> - NO PORT				
	FLANGE x FLANGE				
	A	B	BOLT	C	BOLT
2-1/2"	N/A	N/A	N/A	N/A	N/A
3"	4.0	3.8	4	3.5	4
4"	4.5	4.5	8	3.8	4
5"	5.5	5.0	8	4.5	8
6"	6.0	5.5	8	5.0	8
8"	6.5	6.8	8	5.5	8

SIZE	ACCESSORY FLANGE - ONE 3/4" PORT AND TWO 1/4" PORTS								
	WELD x FLANGE			GROOVE x FLANGE			FLANGE x FLANGE		
	A	B	BOLT	A	B	BOLT	A	B	BOLT
2-1/2"	4.5	3.5	4	6.5	3.5	4	5.6	3.5	4
3"	4.5	3.8	4	6.5	3.8	4	5.6	3.8	4
4"	6.5	4.5	8	8.5	4.5	8	7.2	4.5	8
5"	6.5	5.0	8	8.5	5.0	8	7.2	5.0	8
6"	6.5	5.5	8	8.5	5.5	8	7.2	5.5	8
8"	7.5	6.8	8	9.5	6.8	8	7.6	6.8	8

WELD NECK OR VICTAULIC FLANGE		
SIZE	C	BOLT
2-1/2"	3.5	4
3"	3.75	4
4"	4.5	8
5"	5.0	8
6"	5.5	8
8"	6.75	8

REDUCER THREADED FLANGE		
SIZE	C	BOLT
2-1/2"x1-1/4"	3.5	4
2-1/2"x1-1/2"	3.5	4
2-1/2"x2"	3.5	4
3"x1-1/2"	3.75	4
3"x2"	3.75	4
4"x2"	4.5	8

FLANGED TEE				
SIZE	A	B	Bolt	C
2-1/2"	10.0	3.5	4	5.0
3"	11.0	3.75	4	5.5
4"	13.0	4.5	8	6.5
5"	14.0	5.0	8	7.0
6"	16.0	5.5	8	8.0
8"	18.0	6.75	8	9.0

**NOTES**

<sup>1</sup> All dimensions are subject to change without notice. Length dimensions may vary by ± 2". Please contact factory at time of order for current dimensions.

<sup>2</sup> Flange Reducer is one line size reduction. For example 4" x 3".

Replaces form F-4403B

This specification © 2006 Griswold Controls

**MODEL NUMBER SELECTION**

	ACCESSORY FLANGE					
	WELD x FLANGE		GROOVE x FLANGE		FLANGE x FLANGE	
	(1) 1/4"	(2) 1/4", (1) 3/4"	(1) 1/4"	(2) 1/4", (1) 3/4"	(1) 1/4"	(2) 1/4", (1) 3/4"
2-1/2"	8276-01	8276-06	8276-11	8276-16	8276-31	8276-37
3"	8276-02	8276-07	8276-12	8276-17	8276-32	8276-38
4"	8276-03	8276-08	8276-13	8276-18	8276-33	8276-39
5"	8276-04	8276-09	8276-14	8276-19	8276-34	8276-40
6"	8276-05	8276-10	8276-15	8276-20	8276-35	8276-41
8"	8276-21	8276-22	8276-23	8276-24	8276-36	8276-42

SIZE	FLANGE REDUCER	WELDNECK FLANGE	VICTAULIC FLANGE	FLANGED TEE
2-1/2"	N/A	8282-10	9680-61	8276-25
3"	8276-54	8282-05	9680-62	8276-26
4"	8276-52	8282-06	9680-63	8276-27
5"	8276-49	8282-07	9680-64	8276-28
6"	8276-46	8282-08	9680-65	8276-29
8"	8276-43	8282-09	9680-66	8276-30

SIZE	REDUCER THREADED FLANGE
2-1/2"x1-1/4"	8282-43
2-1/2"x1-1/2"	8282-42
2-1/2"x2"	8282-39
3"x1-1/2"	8282-44
3"x2"	8282-40
4"x2"	8282-41

**OPTIONS (ORDER AS SEPARATE LINE ITEMS):**

- Pressure/Temperature Test Valve – 1/4": 6889
- Manual Air Vent – 1/4": 738-01
- Thermowell – 3/4"x2" Stem: 6889-11
- Thermowell – 3/4"x4" Stem: 6889-12
- Drain Valve 1/4": 9133-02